

Package contents (parts are not to scale):

A



B



C

Part	Description	Quantity
A	Fixture body	1
B	SS Self-Tapping screw	2
C	Wall expansion particle	2

Decoration ring(not include):

Decoration ring for selectable: White, Matt black/matt black, Matt black/gold, Silver and Chrome (not include)

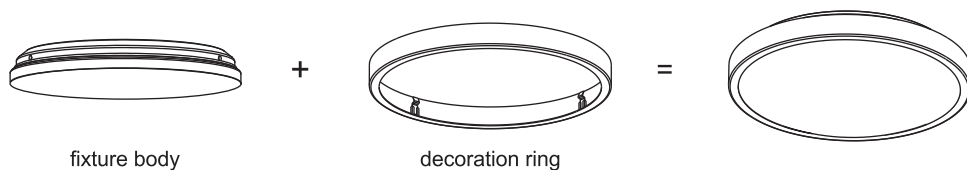

Parameters:

Rated Wattage	Rated Voltage	Color Temperature	Lumen	Life Time	CRI	IP Class	Dimension
24W	220-240V	3000K	2000LM	25000H	>80	IP44	400*70mm

Care and Cleaning

EXTERIOR MAINTENANCE

1. To clean the outside of the fixture, use a dry or slightly dampened clean cloth (use clean water, never a solvent) to wipe the surface of the fixture.
2. Do not use any cleaners with chemicals, solvents or harsh abrasives. Use only a dry soft cloth to dust or wipe carefully.

INTERIOR CEILING

Art Nr. 80168-040-53

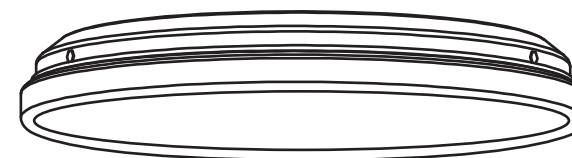

CAUTION:

If the flexible wire or cord of this light is damaged, it should substitute its technic. Service exclusively or a person of equivalents qualifications with the object of avoids any risk of electric shock.

Pre-Installation

PLANNING THE INSTALLATION

Read all instructions before assembly and installation. Before starting installation of the fixture or removal of a previous fixture, disconnect the power by turning off the circuit breaker or by removing the fuse at the fuse box. To avoid damaging this product, assemble it on a soft, non-abrasive surface such as carpet or cardboard.

TOOLS REQUIRED

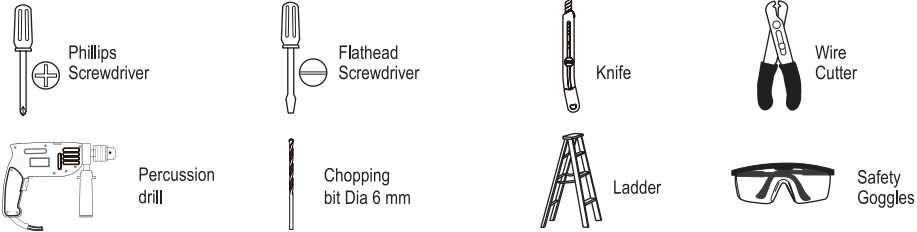

INSTALLATION (FOR INTERNAL USE ONLY) :

Step 1.

Make sure to turn off the main power.

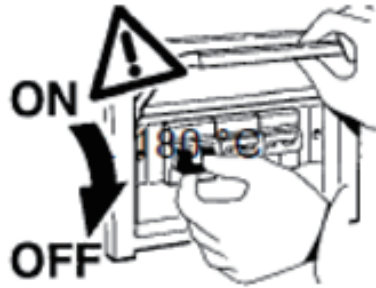

Step 2.

Remove cover from fixture, and pull the power supply wires out the fixture pan, screw the fixture pan on ceiling.

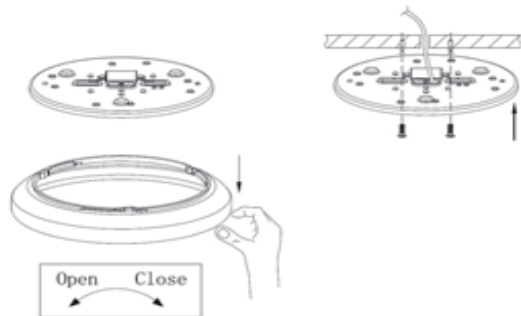

Installation (continued)

Step 3.

Connect the Power supply wires to the Terminal block.

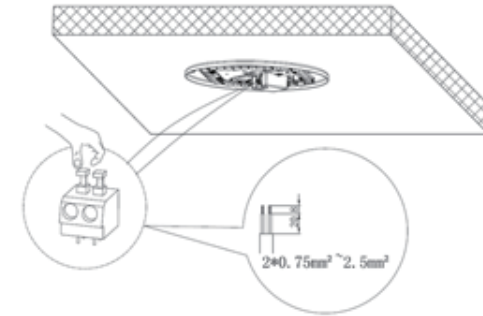

Step 4.

Twist the Fixture cover clockwise.

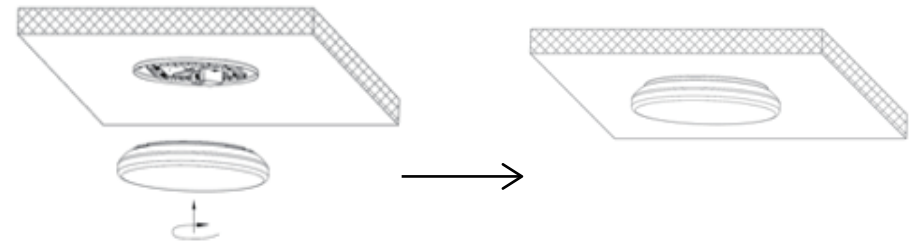

Step 5.

Turn the power switch back on to verify that the product is working properly.

