

## Package contents (parts are not to scale):

A

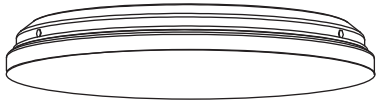

B



C

Part	Description	Quantity
A	Fixture body	1
B	SS Self-Tapping screw	2
C	Wall expansion particle	2

## Decoration ring(not include):

Decoration ring for selectable: White, Matt black/matt black, Matt black/gold, Silver and Chrome (not include)

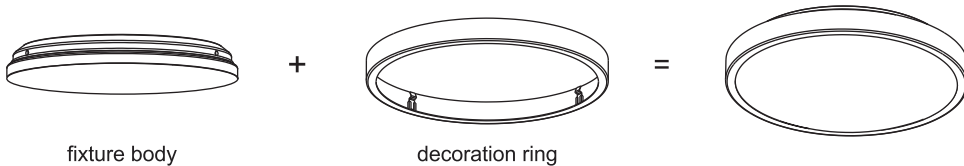

## Parameters:

Rated Wattage	Rated Voltage	Color Temperature	Lumen	Life Time	CRI	IP Class	Dimension
14W	220-240V	3000K	1200LM	25000H	>80	IP44	300*65mm

## Care and Cleaning

### EXTERIOR MAINTENANCE

1. To clean the outside of the fixture, use a dry or slightly dampened clean cloth (use clean water, never a solvent) to wipe the surface of the fixture.
2. Do not use any cleaners with chemicals, solvents or harsh abrasives. Use only a dry soft cloth to dust or wipe carefully.

## INTERIOR CEILING

Art Nr. 80168-030-53

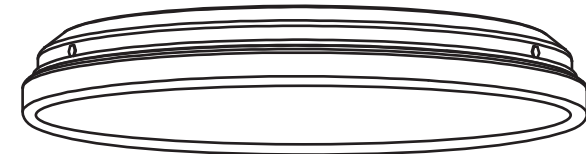

### CAUTION:

If the flexible wire or cord of this light is damaged, it should substitute its technic. Service exclusively or a person of equivalent qualifications with the object of avoids any risk of electric shock.

## Pre-Installation

### PLANNING THE INSTALLATION

Read all instructions before assembly and installation. Before starting installation of the fixture or removal of a previous fixture, disconnect the power by turning off the circuit breaker or by removing the fuse at the fuse box. To avoid damaging this product, assemble it on a soft, non-abrasive surface such as carpet or cardboard.

### TOOLS REQUIRED

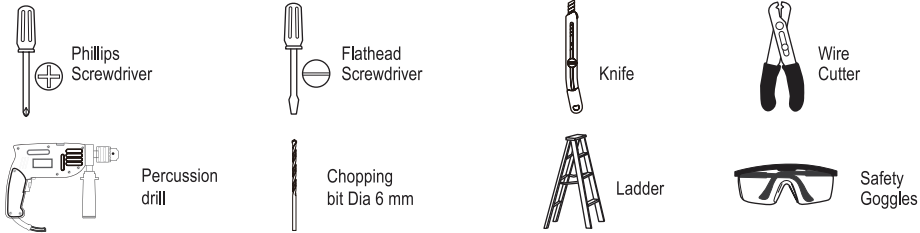

## INSTALLATION (FOR INTERNAL USE ONLY) :

### Step 1.

Make sure to turn off the main power.

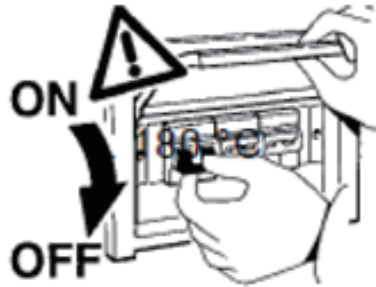

### Step 2.

Remove cover from fixture, and pull the power supply wires out the fixture pan, screw the fixture pan on ceiling.

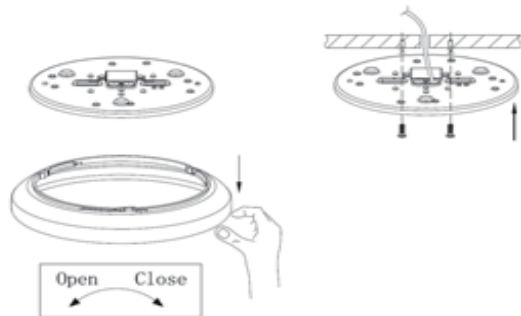

## Installation (continued)

### Step 3.

Connect the Power supply wires to the Terminal block.

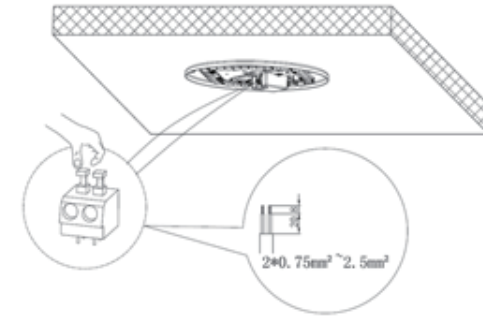

### Step 4.

Twist the Fixture cover clockwise.

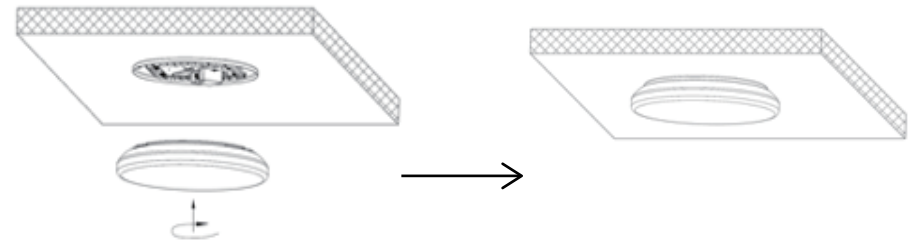

### Step 5.

Turn the power switch back on to verify that the product is working properly.

